

Installation Manual

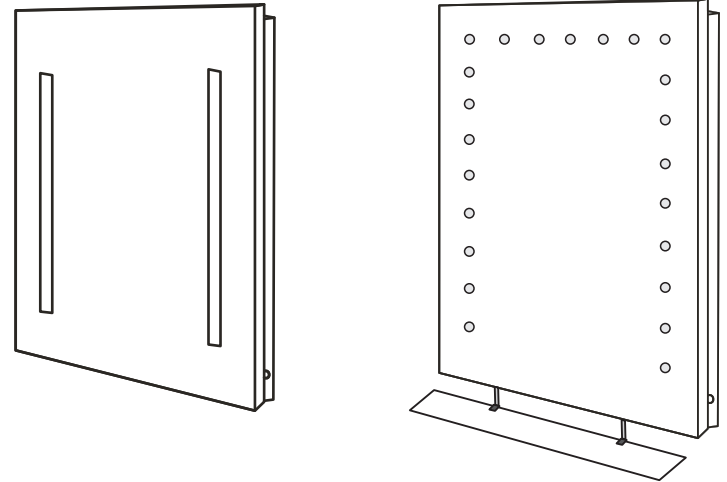

Please retain this manual after installation for future reference and maintenance.

Images are for installation purposes only.



IMPORTANT

Handle with care, impact can damage the mirror.

Use of safety equipment is advised.

Class II approved product (double insulated)
does not need earth wire.

Tools Required(not provided)

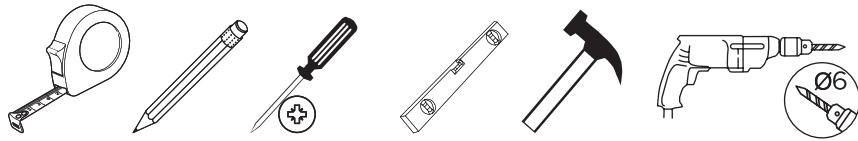

Electrical Safety Installation Information

PLEASE NOTE:

- All electrical products should be fitted by a suitably qualified electrician in accordance with national wiring regulations (BS7671).
- Ensure mains power supply is switched off before starting any electrical installation.
- Before drilling, ensure there are no hidden cables or pipes in the wall.
- When installing this LED mirror please ensure that the connection to the mains electrics is outside of a 60cm radius of any water source as shown in the diagram.

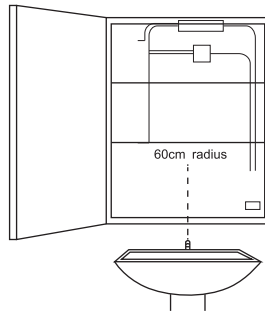

Product Specification

Wattage	Max.15W
Voltage	220-240V, 50Hz
Certificate	CE, IP44, RoHS

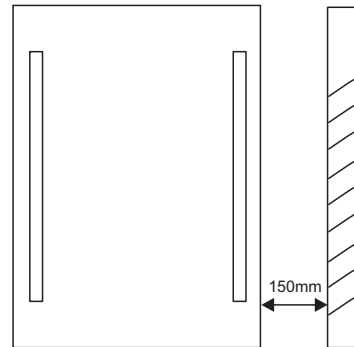

Ensure the sensor are positioned at least 150mm away from any solid surface including walls.

1

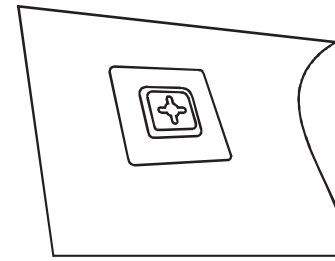

check 4-1

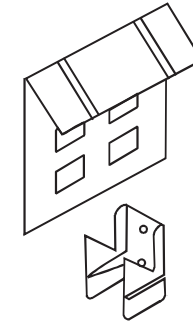

check 4-2

Please Note: There are two different types of fitting bracket please check which style is on the mirror you have purchased.

2

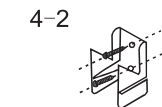
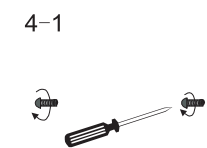
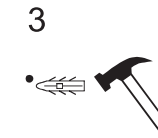
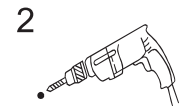

3

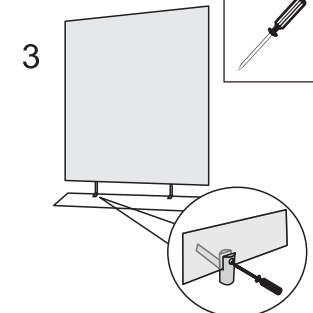
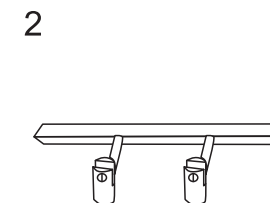
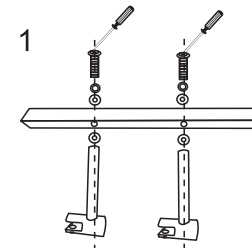

If a product comes without glass shelf, please ignore step 3.

4

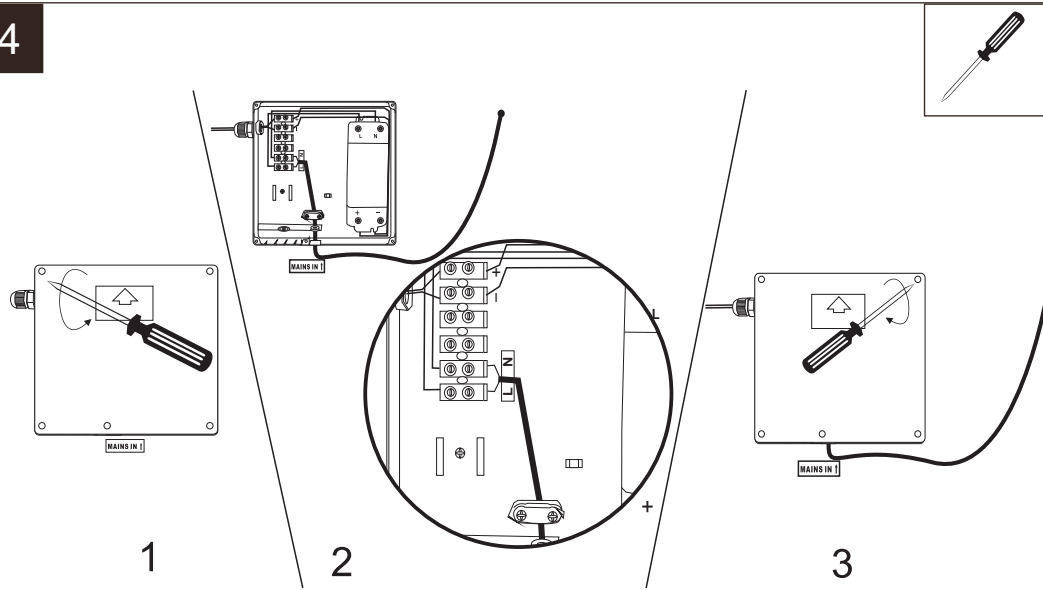

5

If the product comes with a clock, please further follow step 5.

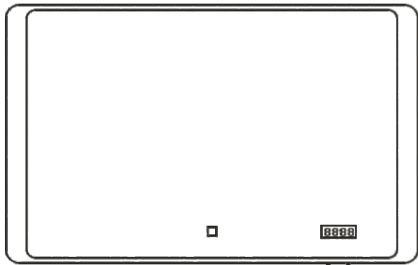

a) Press and hold the left button till the Hr/Min digits flash.

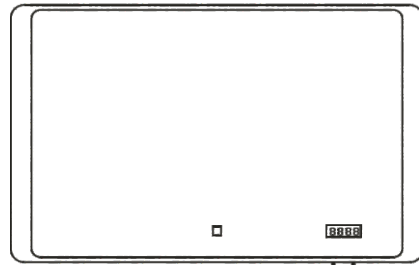

b) Press the right button to reset the Hr/Min.

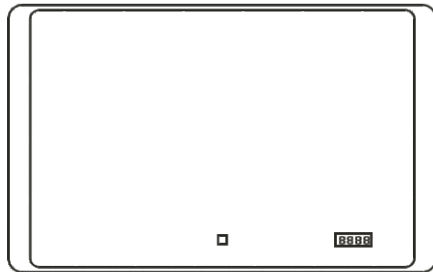

c) Press the left button again to end the setting.

1. We guarantee our products to be free from defects in materials and workmanship.

2. Our obligations under this warranty are limited to repairing, replacing or other appropriate measures, at our discretion of the product or parts found to be defective in normal use. This is providing that the said product was properly installed, used and serviced in accordance with our instructions. We reserve the right to make such inspections as may be necessary to determine the cause of the defect. We will not charge labor or parts as a result of warranty repairing or replacements.

3. This warranty does not apply to the following situations:

a) Damage or loss resulting from any accident, unreasonable use, misuse, abuse, negligence, or improper care, cleaning, or maintenance of the product.

b) Damage or loss resulting from improper installation or from installation of the product in a harsh and/or hazardous environment, or improper removal, repair or modification of the product.

c) Damage or loss resulting from electrical surges or lightning strikes or other acts which are not the fault of us or which the product is not specified to tolerate.

d) Damage or loss resulting from normal and customary wear and tear, such as gloss

reduction, scratching or fading over time due to use, cleaning practices or water or atmospheric conditions, including but not limited to, the use of bleach, alkali, acid cleaners, dry (powder) cleaners or any other abrasive cleaners or the use of metal or nylon scrubbers.

4. All surfaces should be wiped down with a clean cloth, no abrasive cleaning agents or material's can be used.

Telephone
0333 777 4777