

Exposed Bath Waste

Installation

Depending on the bath, the overflow tube may require cutting to length.

When cutting take care to cut straight and remove sharp burrs afterwards, which can damage the seals.

Ensure that the cut still allows sufficient tube to fit inside the waste fittings

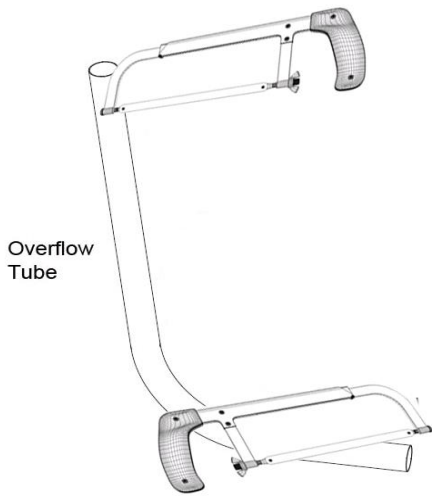

Sealant should be applied between the waste flange and the bath.

Plus applied between the rubber seals and the bath as an additional seal.

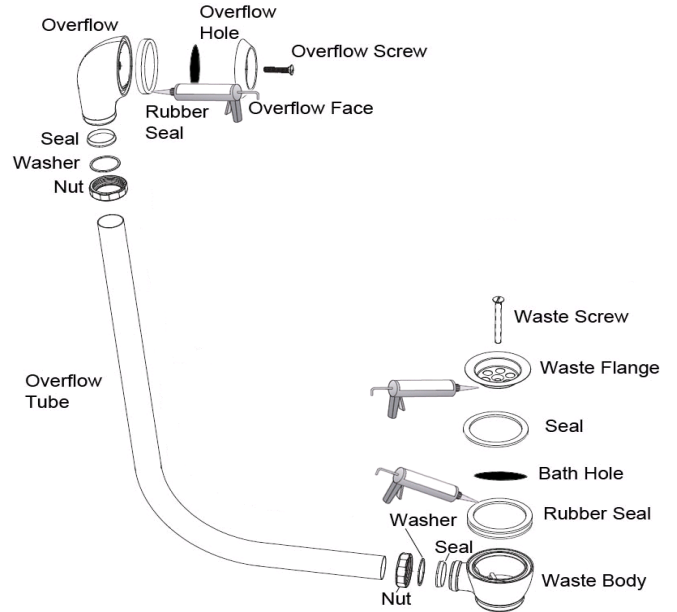

Place the nuts over each end of the tube, followed by the washer and finally by the angled seal, taking care not damage this on the end of the tube.

Push the tube ends into the overflow and waste body and connect the nuts.

Offer the assembly to the bath and connect the overflow face to the overflow, using the screw provided, do not fully tighten

Next connect the waste flange to the waste body using the long screw provided.

Then align the tube and tighten all connections.

Remove any excess sealant

Connect the chain to the overflow face and plug.

Clean the product surface using only a clean damp cloth, use of abrasive cleaning agent or materials should not be used, or this will invalidate your guarantee.

When using sealant we recommend not using the bath for at least 24 hrs after the application to allow full drying

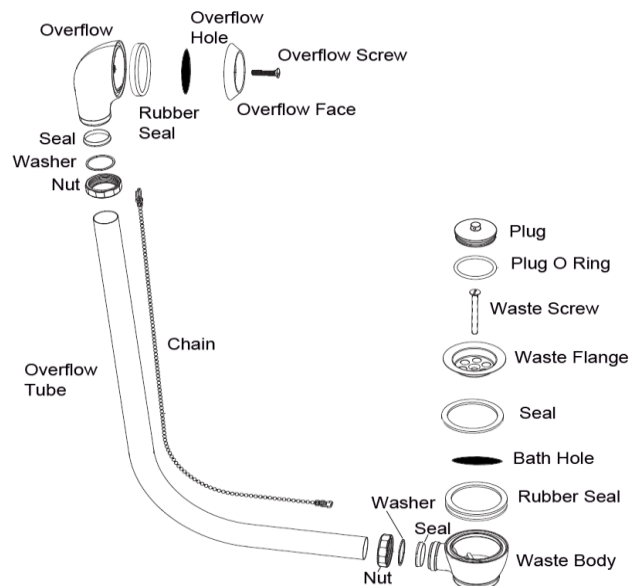

Telephone
0844 484 7678