

This instruction is used on code:10031

Thank you for using our products. In order to install our product, please follow the instructions below and check all components are present before commencing. Prepare all the needed tools and materials for installation.

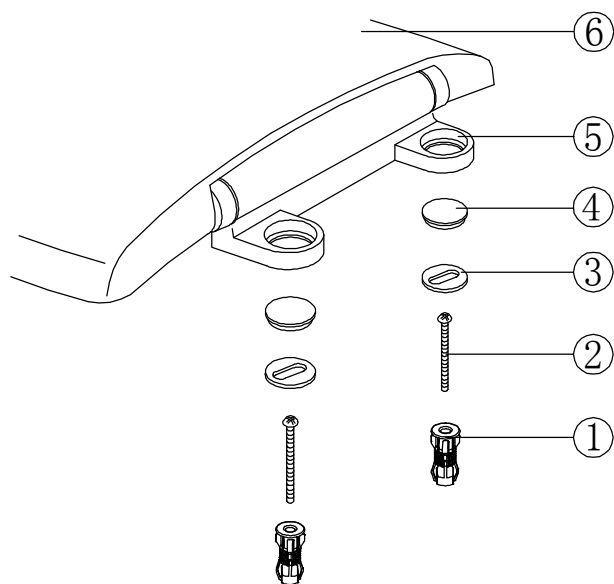

①	expanding plug	④	hinge cover
②	screw	⑤	hinge
③	adjustable plate	⑥	seat cover

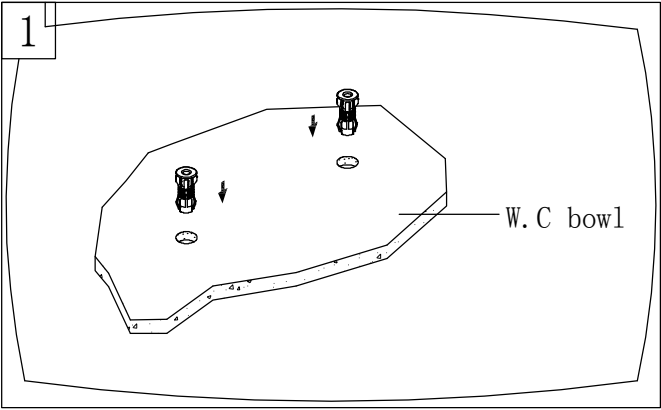

1. Push the plug into the holes on the toilet pan tightly.

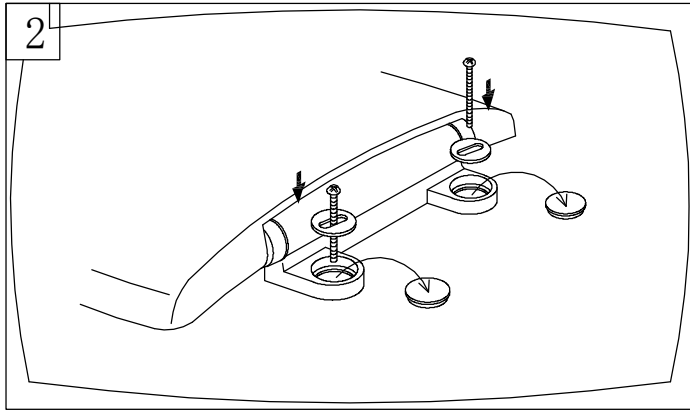

2. Remove the hinge cover from the seat cover
Place the adjustable plate into the seat
Place the screw into the adjustable plate

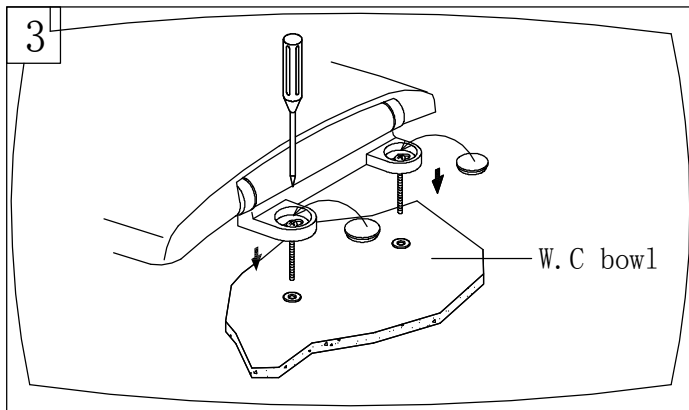

3. Place the seat cover to the pan and line up the hinge and the holes on the pan. Make the necessary adjustment to the fittings so that the seat sits correctly on the toilet. Once correctly positioned, use screwdriver to fit the screws to the plugs. Then push the hinge cover into the hinge.

Importance:

- * After installation ensure the fixings are fully secured
- * No abrasive cleaning agents or materials can be used, a soft clean cloth should be used
- * During use do not push the seat down, as this will cause damage to the soft close mechanism

For further details or advice call Customer Services on 0844 484 778