

Product Specification

| | |
|---------------------------------|---|
| Minimum Working Pressure | 0.8 bar |
| Maximum Working Pressure | 3.0 bar |
| Connections | 1/2" |
| Rail Diameter | 22mm |
| Handset | Number of functions on handset: 5 - Spray - Mist - Massage - ECO spray - Pause |
| Hose | 1.5m to handset 800mm mixer to diverter |

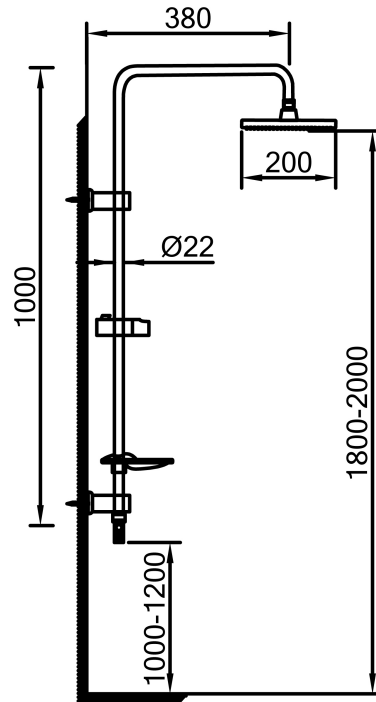

Dualex Riser Rail Kit

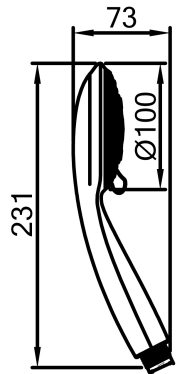

Please retain this manual after installation for future reference and maintenance.

Product must be installed in compliance with relevant Water Bylaws

Telephone
0844 484 7678

Installation

Mark position of mounting bracket locations on wall, ensuring not to damage any pipes or wires.
 Drill holes and insert plugs.
 Fit mounting brackets to wall.

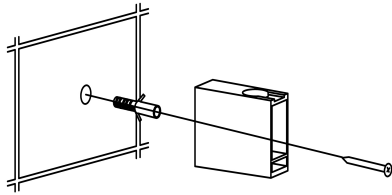

Fit adjustable rail bracket first, to rail.
 Fit slider to rail, ensuring to press button when sliding, with the wider opening on the holder upwards.
 Fit the soap dish to the rail and secure by twisting the grey grip underneath the soap dish

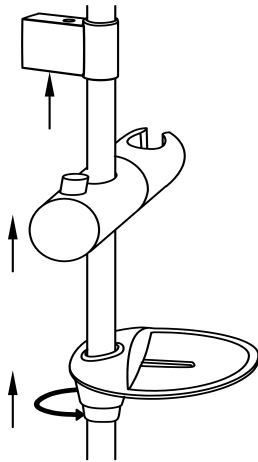

Place the round chrome nut onto the rail.
 Fit the brass adaptor with o rings into the end of the rail and tighten using an allen key.
 Fit rubber washer into the chrome nut.
 Connect diverter to the rail nut and tighten, ensure that the diverter is aligned with the rail.

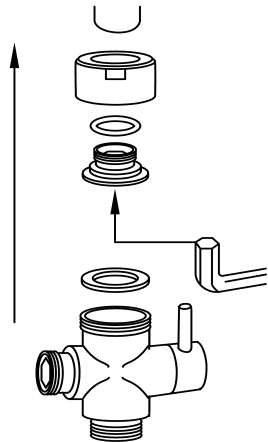

Cleaning

The product should be cleaned using a soft damp cloth, no abrasive agents or materials must be used, or this will invalidate your guarantee.

Box Contents

| Contents | | Material | Qty |
|----------|-----------------------|----------|-----|
| 1 | Hose SDF80 | S/S | 1 |
| 2 | Washer for Hose G1/2" | NBR | 1 |
| 3 | Washer for Hose G1/2" | NBR | 1 |
| 4 | Water Diverter | ABS | 1 |
| 5 | Washer for G3/4" | NBR | 1 |
| 6 | Connector | BRASS | 1 |
| 7 | Oring for Connector | NBR | 1 |
| 8 | Screw Cap F3/4" | BRASS | 1 |
| 9 | Washer for Hose G1/2" | NBR | 1 |
| 10 | Hose SDF 150 | S/S | 1 |
| 11 | C.P.Center Soap Dish | ABS | 1 |
| 12 | Slider-C 22 | ABS | 1 |
| 13 | Washer for Hose G1/2" | NBR | 1 |
| 14 | Hand shower | ABS | 1 |
| 15. | Shower Head | ABS | 1 |
| 16 | Washer with filter | NBR | 1 |
| 17 | Rail | S/S | 1 |
| 18 | Wall bracket | ABS | 2 |
| 19 | Screw ST4*30MM | S/S | 2 |
| 20 | Insert | ABS | 2 |
| 21 | Screw ST5*40MM | S/S | 2 |
| 22 | Bracket fixing | ABS | 2 |
| 23 | Wall plug 8*40MM | PE | 2 |

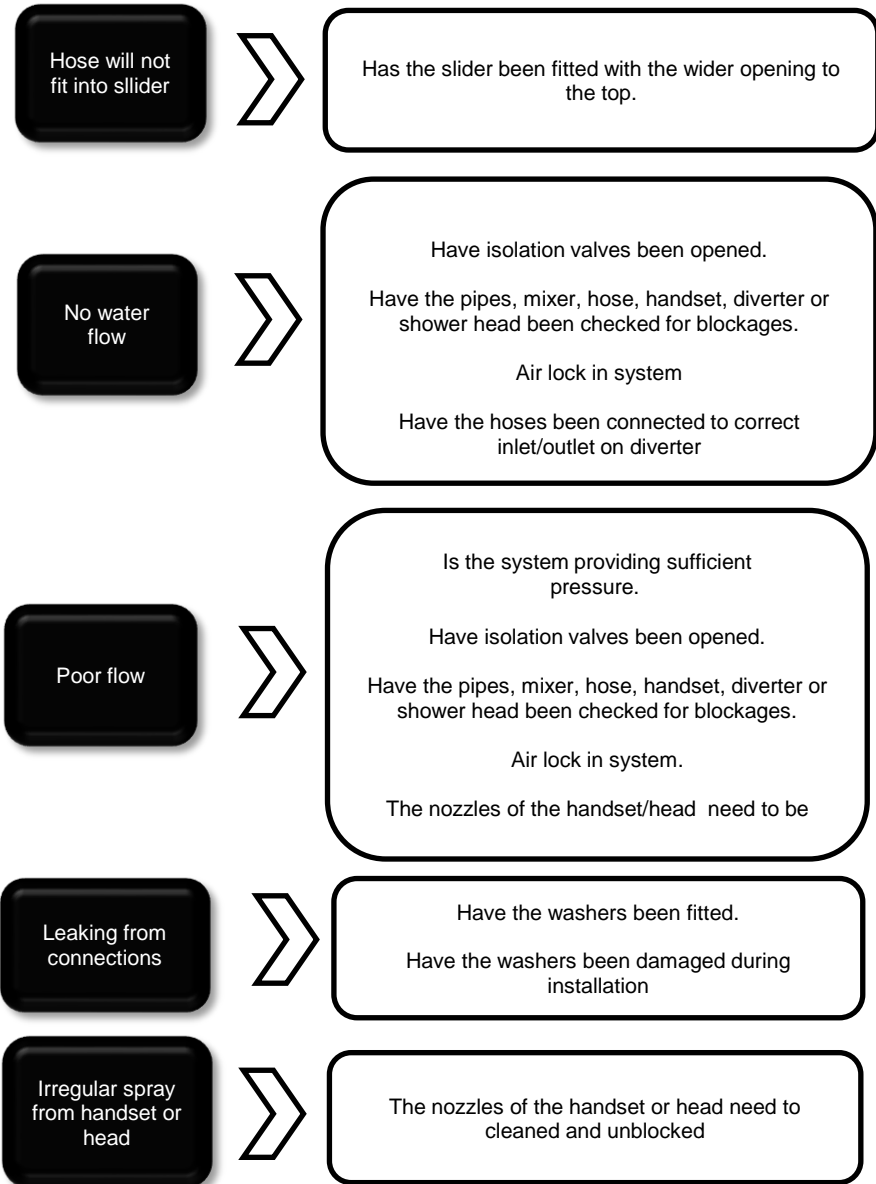

Installation

Place the insert into the bracket fixing, ensure that the two holes in the same line.

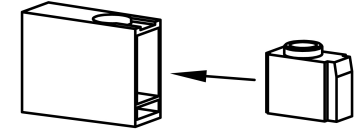

Place the insert and bracket fixing into the the wall bracket and secure using the screws provided.

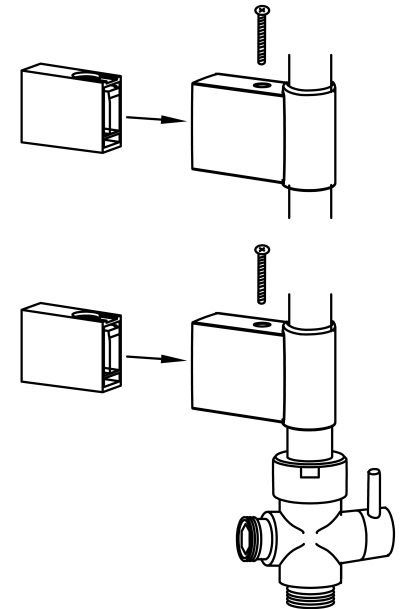

Installation

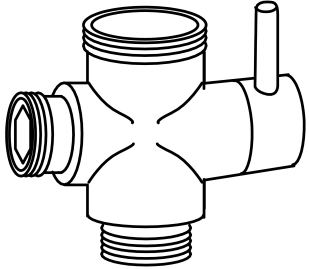

Place seals into hose ends.
 Connect long hose to thread to side of diverter.
 Connect opposite end to the handset

Connect the short hose to the thread at the bottom of the diverter.
 The opposite end should be connected to the mixer.

Place the hose filter seal into the cone of the hose.
 Connect the handset to hose.
 Fit cone of the hose into the handset holder on the slider.

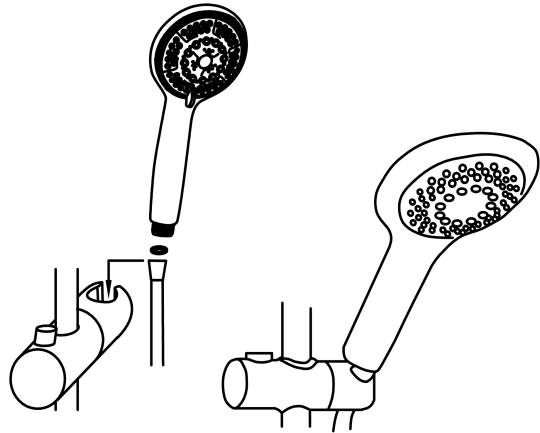
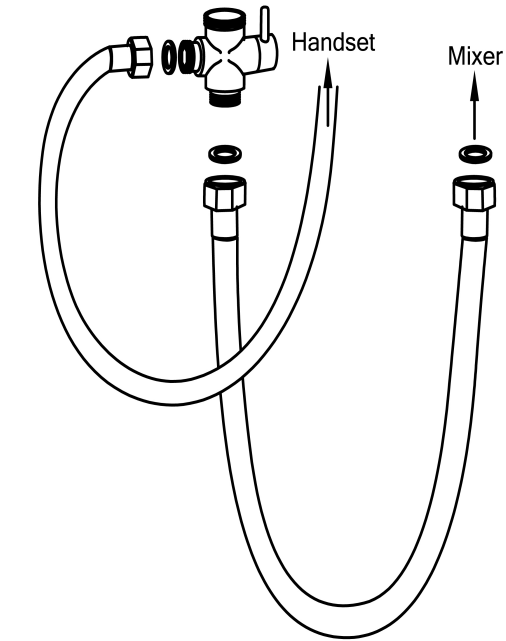

Parts

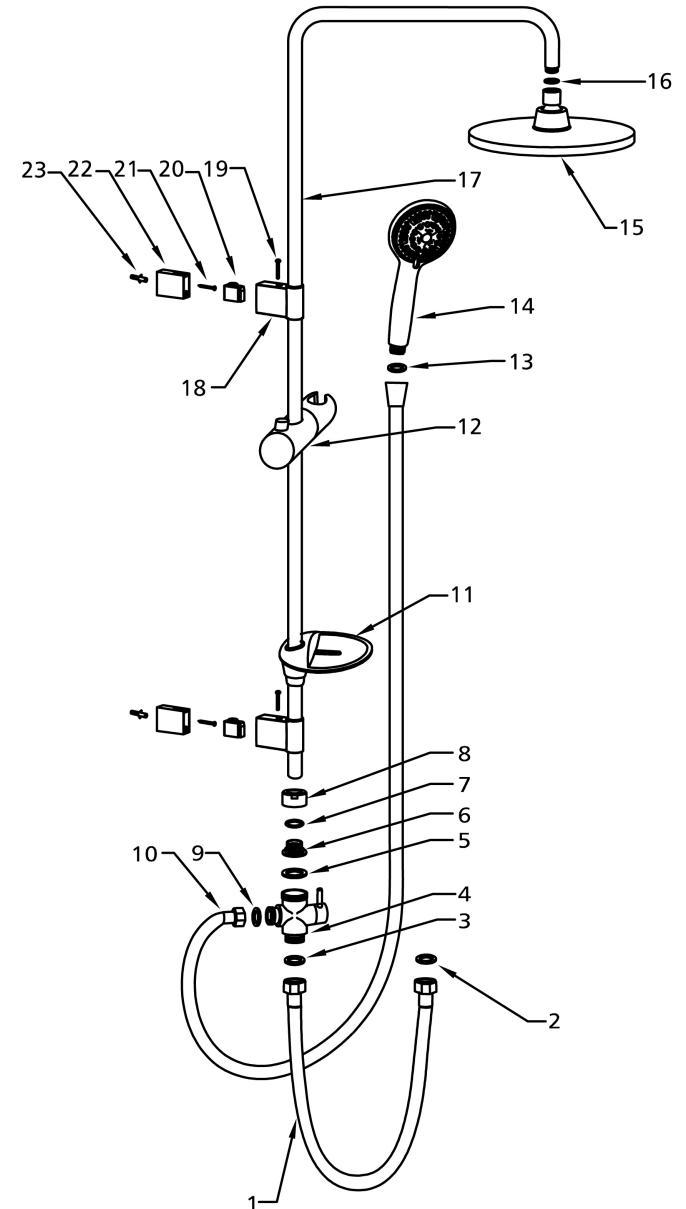

Operation

To divert the flow between shower head and handset, turn the small lever on the diverter.

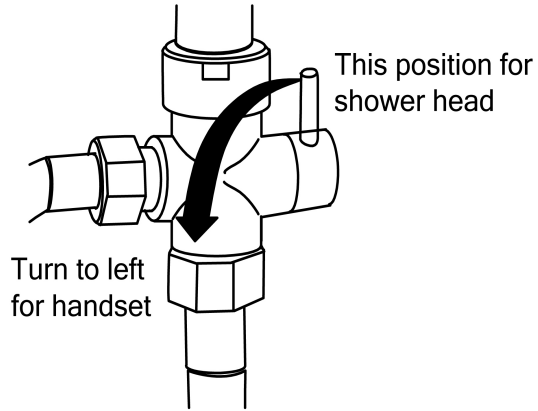

To adjust the height of the handset, press the button on the slider and push the slider bracket until required height is reached and release the button (do not move the slider without pressing the button)

To adjust the angle of the handset in the holder, gently pull the handset just above the slider bracket.

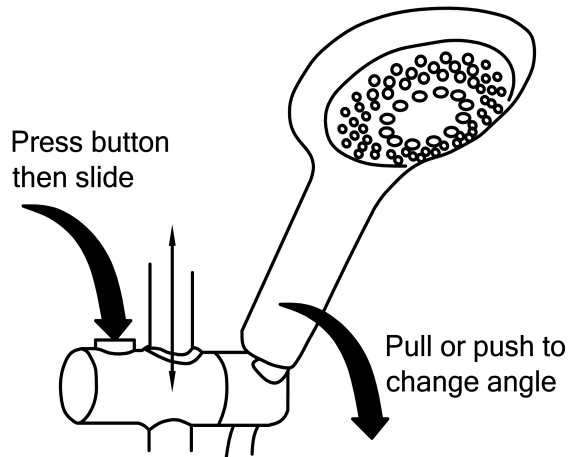

Installation

Place the filter seal into the swivel joint of the shower head.

Connect shower head to arm and tighten.

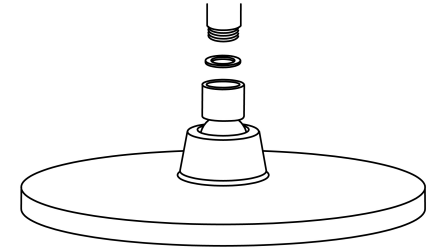

Operation

As the handset has 5 modes, to select the required spray, hold the small lever and turn, until desired spray pattern has been reached.

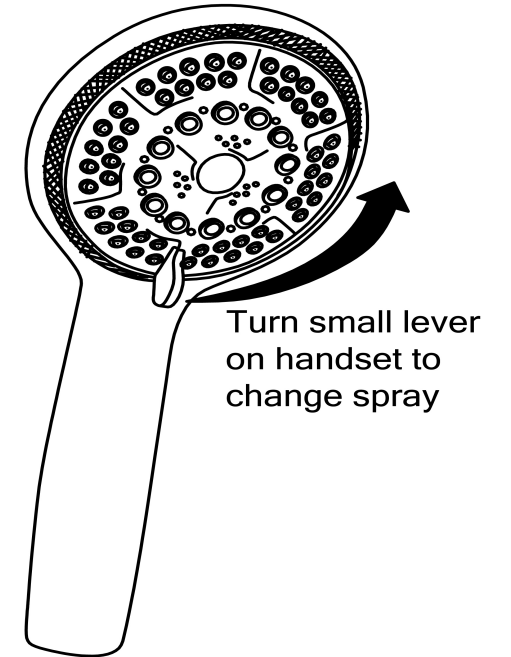

Guarantee

Not covered by the guarantee is:

- Breakdown due to -
 - a) Use other than domestic
 - b) Wilful act of neglect
 - c) Any malfunction resulting from incorrect use
 - d) Incorrect setting of controls
 - e) Any malfunction resulting from poor water quality
- Repair costs for damage caused by foreign objects or substances
- Total loss of the product due to non-availability of parts
- Compensation for loss of use of the product or consequential loss of any kind.
- Call out charges where no fault has been found with the product.

Not covered by the guarantee is:

- The cost of repair or replacement of pressure relief devices, spray heads, hoses, riser rails and/or wall bracket or any other accessories installed at the same time.
- The cost of routine maintenance, adjustments, overhaul, modifications, loss or damage, arising therefrom, including the cost of repairing damage, breakdown, malfunction caused by corrosion, furring, pipe scaling, lime scale, system debris or frost.