

# USER MANUAL



Thank you for choosing Better Bathrooms.  
Please read this manual before installing your product  
and keep for future reference.

better  
bathrooms

## Product Name — Bracket With Hose

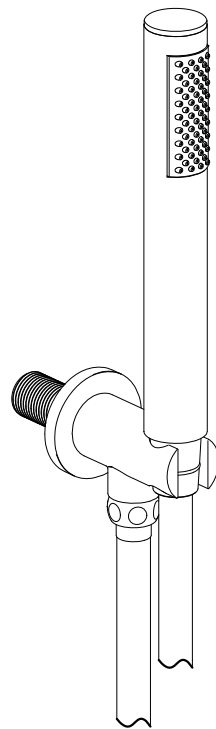

**Please note: Image is for illustrative purposes only and may differ slightly to the actual product**

- **Single-person assembly**
- **We always recommend using professional tradespeople to install your product**

V1\_02. 18. 2025

# **Congratulations on your purchase**

**And welcome to our growing gang of savvy shoppers**

**We're on a mission to bring you extraordinary bathroom products, for less. From modern to traditional style ceramics, plus the gorgeous fixtures, fittings and furniture to match. So, you can fall in love with your space every single day .**

**As one of the UK's largest independent bathroom stores, we've received countless awards; including the National Business Awards UK, the Digital Entrepreneur Awards and being placed on The Sunday Times Fast Track 100.**

**We hope your new product exceeds your highest expectations. However, if you experience any problems, please:**

- **log in to your account and contact our customer services team via your self-serve portal-[betterbathrooms.com/CustomerAccount/Login](https://betterbathrooms.com/CustomerAccount/Login).**
- **contact us via-[betterbathrooms.com/content/contact-us](https://betterbathrooms.com/content/contact-us).**

## **Important information**

- **Please read these instructions thoroughly and retain for future reference**
- **Manufactured to BS EN1112 Shower outlets for sanitary tapware**

# Parts

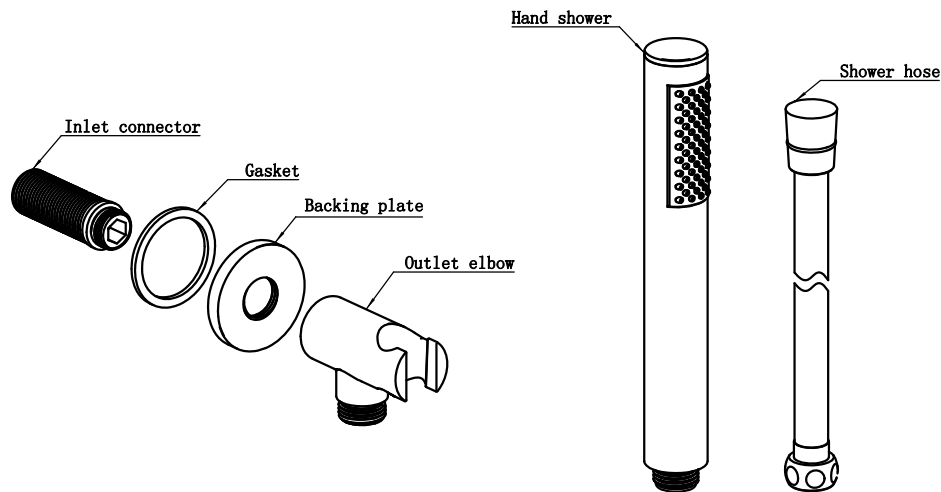

1. Drill hole (size  $\text{Ø}22\sim 25\text{mm}$ ) on the tile.
2. Connect the elbow to a suitable water connection fitting( not supplied) and seal using PTFE on the thread connector.
3. Turn on water supplies to check if there are any leaks from the water connections.

Make sure there is rubber gasket in both end connectors of shower hose, connect one end of the shower hose to the outlet elbow, and the cone end of the shower hose to the hand shower. Turn on the water supplies, and check for correct operation.

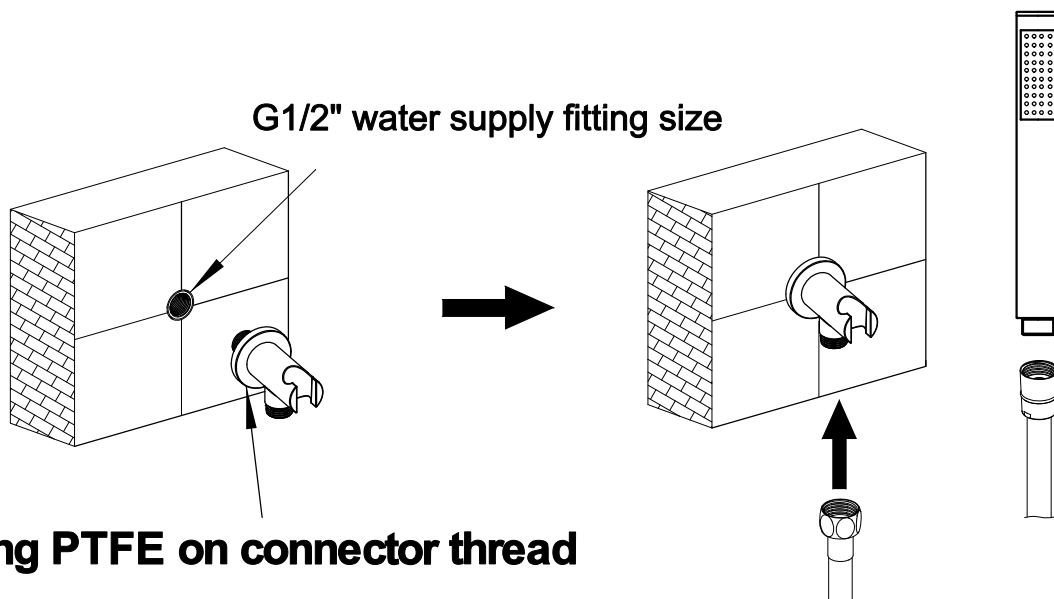

# Troubleshooting

## **Very low flow or no flow**

**Cause: Supply pressure inadequate.**

**Remedy: check the pressure of hot and cold water supply.**

**Cause: Blockage on the aerator.**

**Remedy: Clean the aerator.**

**Cause: Control valve or cartridge (not supplied) failure.**

**Remedy: Replace cartridge or control valve.**

# Maintenance

**To maintain the surface finish of your product, wipe clean after every use, using a clean damp cloth, a mild detergent mixture can be used. Do not use abrasive cleaning agents or materials on the product surface.**

**If any harsh chemicals come into contact with the surface of the product during bathroom cleaning, rinse off immediately, wipe clean and dry**

### ***For more information***

- visit [betterbathrooms.com](http://betterbathrooms.com)
- email [customerservices@buyitdirect.co.uk](mailto:customerservices@buyitdirect.co.uk)
- call 03303903062
- write to Trident Business Park, Neptune Way, Huddersfield, HD2 1UA

**better  
bathrooms**

Part of the BuyItDirect Group