

# Installation Manual

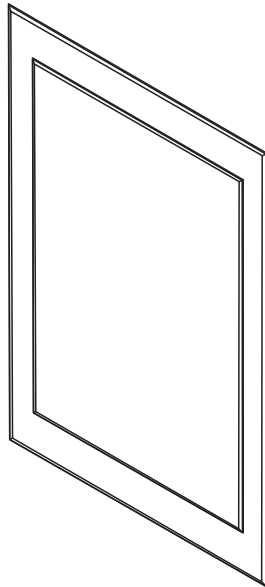

Please retain this manual after installation for future reference and maintenance.

Images are for installation purposes only.



## IMPORTANT

Handle with care, impact can damage the mirror.  
Use of safety equipment is advised

## Tools Required(not provided)

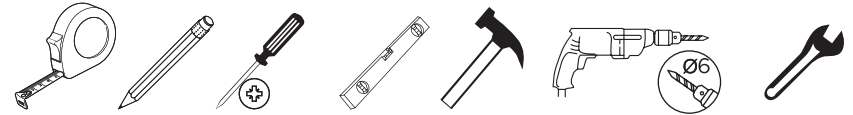

01

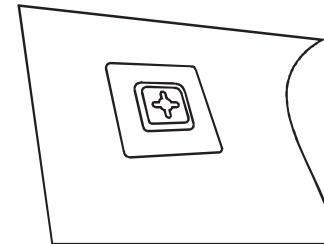

check 4-1

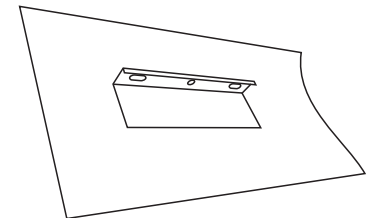

check 4-2

Please Note: There are two different types of fitting bracket please check which style is on the mirror you have purchased.

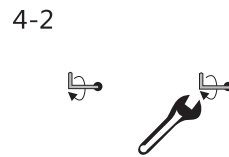
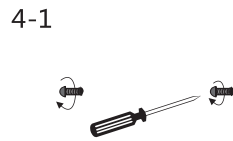
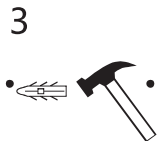
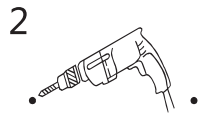
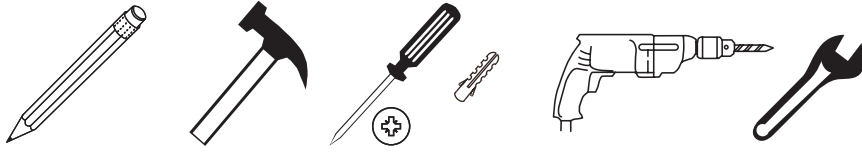

1. Measure the distance between the two brackets on the back of the mirror

Mark the distance on the wall.

2. Check the marks are level and drill the holes.

3.1 If the mirror is secured by screws, insert the wall plug, thread in the screws and hang the mirror onto the screws.

3.2 If the mirror is secured by the hooks, insert the wall plugs, position the hooks and thread in the screws to fix the hooks, then hang the mirror onto the hooks.

**Please note:**

**make sure the holes on the wall and on the hooks are lined up**

1. We guarantee our products to be free from defects in materials and workmanship.

2. Our obligations under this warranty are limited to repairing, replacing or other appropriate measures, at our discretion of the product or parts found to be defective in normal use. This is providing that the said product was properly installed, used and serviced in accordance with our instructions. We reserve the right to make such inspections as may be necessary to determine the cause of the defect. We will not charge labor or parts as a result of warranty repairing or replacements.

3. This warranty does not apply to the following situations:

a) Damage or loss resulting from any accident, unreasonable use, misuse, abuse, negligence, or improper care, cleaning, or maintenance of the product.

b) Damage or loss resulting from improper installation or from installation of the product in a harsh and/or hazardous environment, or improper removal, repair or modification of the product.

c) Damage or loss resulting from electrical surges or lightning strikes or other acts which are not the fault of us or which the product is not specied to tolerate.

d) Damage or loss resulting from normal and customary wear and tear, such as gloss

reduction, scratching or fading over time due to use, cleaning practices or water or atmospheric conditions, including but not limited to, the use of bleach, alkali, acid cleaners, dry (powder) cleaners or any other abrasive cleaners or the use of metal or nylon scrubbers.

4. All surfaces should be wiped down with a clean cloth, no abrasive cleaning agents or material's can be used.

**Telephone**  
**0333 777 4777**